



GENERAL FEATURES

- Rack dimensions: **55x55 cm**
- Net weight: 97 Kg
- Wash cycles/racks per hour: 2'- 3'- 6'- 9' / 30-20-10-7
- Stainless-steel wash/rinse arms easily removable
- Wash pump: 750 W
- Boiler capacity: 5,5 lt
- Tank capacity: 50 lt
- Boiler heating element: 6 kW
- Tank heating element: 6 kW
- Water quantity per cycle: 2 lt
- Useful washing height: 450 mm
- Electronic management with color LCD display showing boiler and tank temperatures, multicolored start button and self-diagnostic system
- PRS System: built-in atmospheric boiler, independent from the water supply pressure, with rinse pump to guarantee constant rinse temperature and pressure throughout the entire rinse phase
- High efficiency air gap (A class)
- Double electric detergent and rinse-aid dispenser
- Thermostop function (hot rinse)
- Green function for energy saving
- Automatic end-of-day self-cleaning of wash tank

FILTRATION

- Pre-filtering of the tank water by means of stainless-steel filter
- Stainless steel pump filter, easily removable

BODY

- AISI 304 stainless-steel body
- Double skinned insulated body
- Preformed wash tank with rounded corners to avoid grime build-up
- Preformed rack guides
- Stainless-steel door handle
- Opening / closing of the amortized door by springs
- Boiler in stainless-steel AISI 316

EQUIPMENT

- 1 stainless-steel trays rack (5 places)
- 1 utensil rack 55x55 cm
- 1 inlet hose (2 mt length)
- 1 drain hose (2,5 mt length)

OPTIONS

- HD version (12,75 kW in 380-415V 3N~)
- Drain pump (DP)
- Hot water filling max 85°C (HW)
- Chemicals level sensors (CLS)
- Wi-Fi connection (WIFI)
- 60 Hz version

WATER TREATMENT ACCESSORIES

- External water softener

ACCESSORIES

- Special racks

WATER SUPPLY CONNECTION

- **Water supply hardness:**
Water hardness between 0 and 14°f (0 ÷ 8°d)
Above 14°f (8°d) suggested water softener
- **Water supply dynamic pressure:**
Standard between 1 and 5 BAR
- **Water supply temperature:**
Standard between 10 and 60°C

MAIN POWER SUPPLY

- The voltage of main power supply must be compatible with the rated voltage
- The machine must be connected to a suitable earth (ground) system
- Connect the machine power socket to the multi-pole wall switch provided

TECHNICAL SPECIFICATIONS

- Electrical supply: **380-415V 3N / 220-240V3 / 220-240V~50Hz (MULTIPOWER)**
- Total power: **6,8 kW (12,75 kW in HD)**
- Absorbed current: **10 A / 17 A / 30 A (21 A in HD)**
- Power cord supply size: **5 x 4 mm² / 3 x 4 mm²**

AU 55.45 EPI PRS

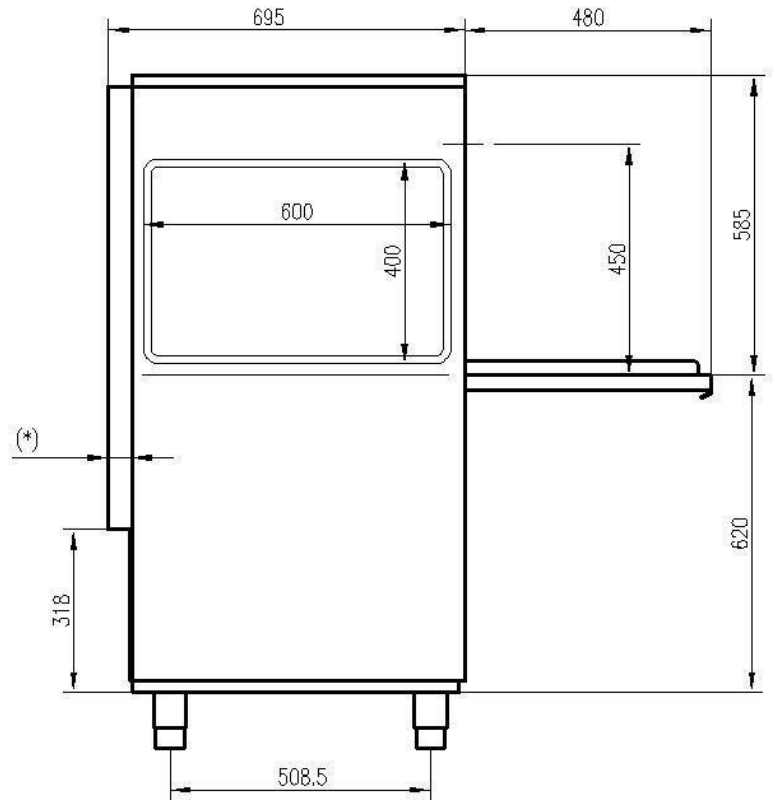
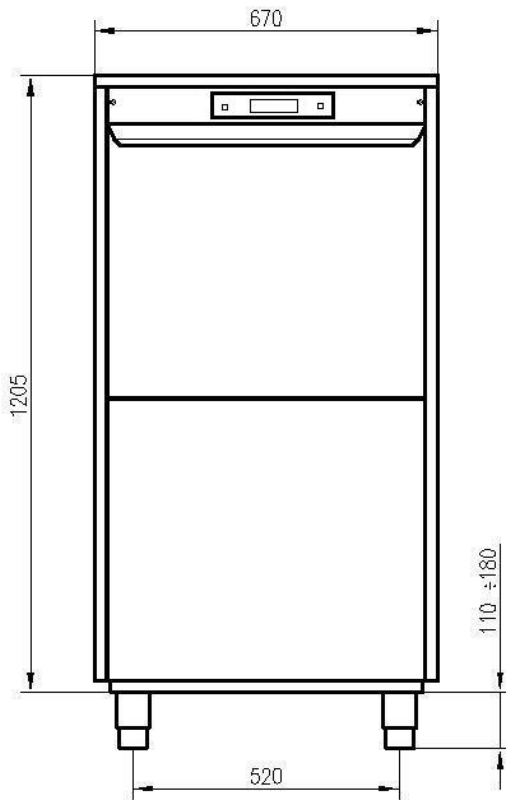

(*)= VANO DI PASSAGGIO TUBI DI CARICO E SCARICO ACQUA
FILO EQUIPOTENZIALE

(*)= PASSAGE FOR WATER OUTLET AND INLET PIPE AND
UNIPOTENTIAL WIRE

(*)= OUVERTURE DE PASSAGE TUYAUX DE VIDANGE, ALIMENTATION EAU
ET CONNEXION EQUIPOTENTIELLE.

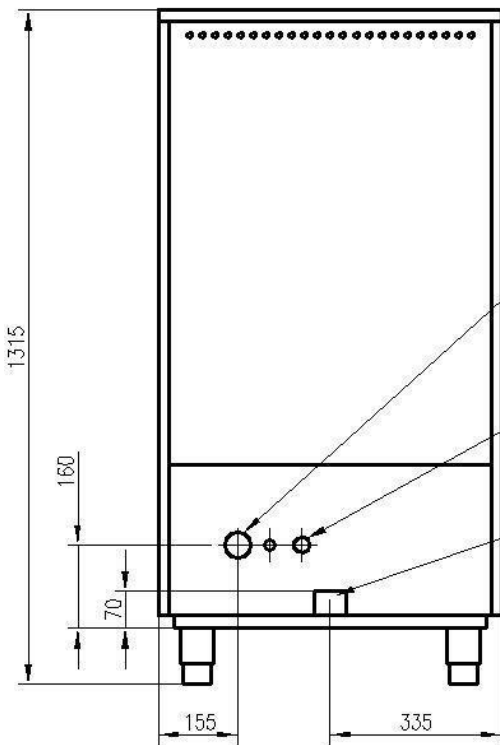

TUBO DI SCARICO Ø INT. mm.28 LUNGHEZZA mm. 2000
EXIT WATER OUTLET PIPE INT. Ø 28 mm. L=mm. 2000.
TUYAU DE VIDANGE Ø INT. 28 mm. L=mm. 2000.

USCITA CAVO DI ALIMENTAZIONE
EXIT POWER CORD SUPPLY
OUVERTURE DE PASSAGE CABLE D'ALIMENTATION

CANNA DI CARICO CON ATTACCO G 3/4" LUNGHEZZA mm. 2000.
WATER INLET PIPE CONNECTION G 3/4" L=mm 2000.
TUYAU D'ALIMENTATION EAU AVEC CONNEXION G 3/4" L=mm 2000.

VISTA POSTERIORE
REAR OF MACHINE
VUE ARRIERE

| | |
|--|--|
| | Min 10°C-MAX 50°C Min 10°C-MAX 25°C with ENERGY RECOVERY |
| | 200±500kPa(2±5 Bar) 100±500kPa(1±5 Bar) with ATMOSPHERIC BOILER |
| | HARDNESS 5±20f-2.8±11'd |